



MAGIKA

1:8 OFF-ROAD RACING BUGGY

Un nuovo ed entusiasmante OFF-ROAD da competizione va ad aggiungersi alla già collaudata linea MANTUA MODEL che, da anni sta proponendo ai modellisti di tutto il mondo il meglio dell'1:8.

Per le sue caratteristiche tecniche, semplicità di montaggio e regolazioni, la MAGIKA è destinata a rimanere parecchio tempo sulla breccia, e ne fa il modello da battere degli anni '90. La linea armoniosa ed elegante, la facilità di guida e le brillanti prestazioni, la rendono senz'altro l'OFF-ROAD del momento.

A new and fascinating competition OFF-ROAD car is ready to enter in the MANTUA MODEL legend.

The strong construction, the easy assembly and maintenance make the model a top car for any important race as well as for the amusement.



2WD

Rear differential

Art. 24200

4WD

Three differentials

Art. 24201

4WD PRO

With central Torsen differential

Art. 24202

4WD PRO COMP.

- With central Torsen differential
- To lock a wheel
- Front & rear permanent oil shock absorber \varnothing 14 mm

Art. 24203



31



31

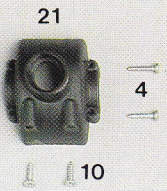

21



26



21

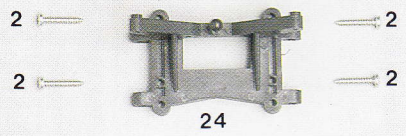
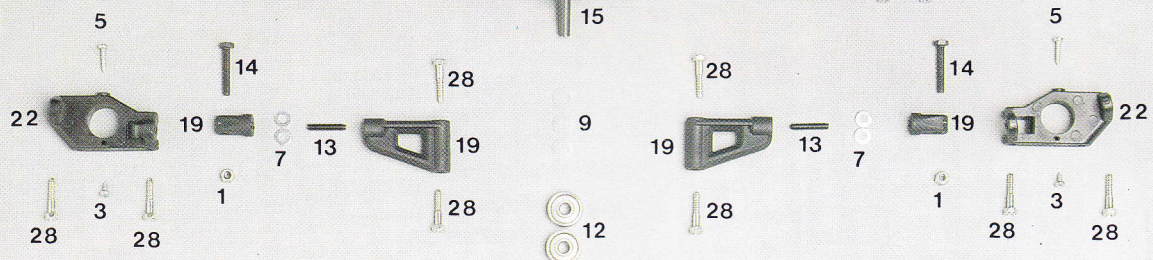
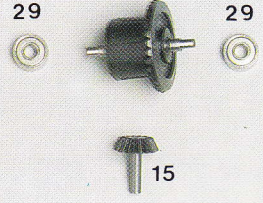

24

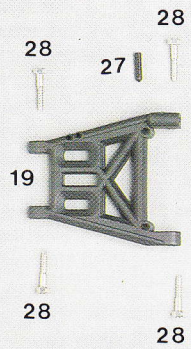

19

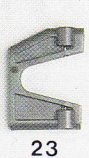

23

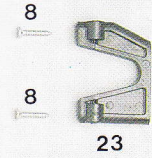

23

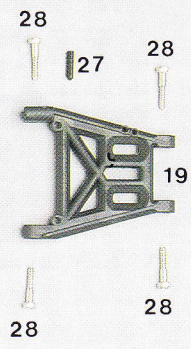

19

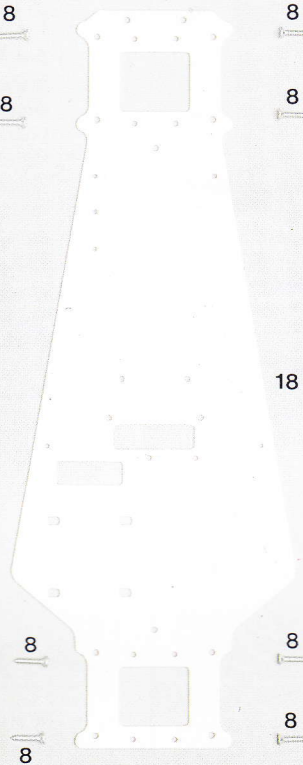

18

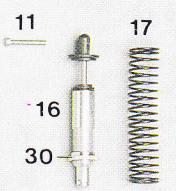
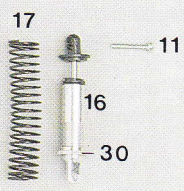

A

RICAMBI SPARE PARTS

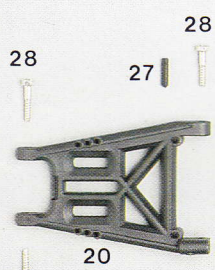
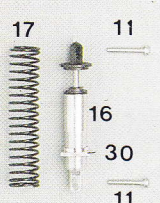

20

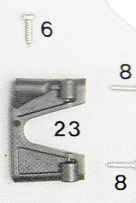

23

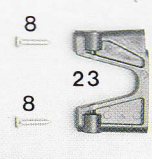

23

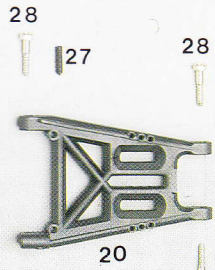

20

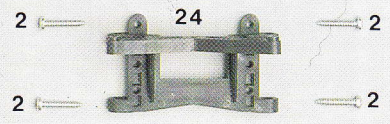

24

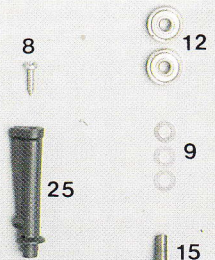
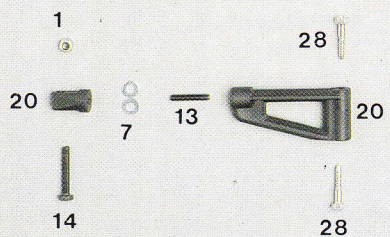

25

25

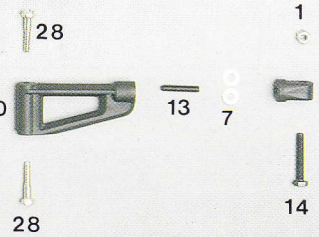

31

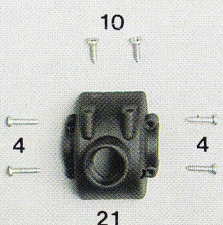

21



26

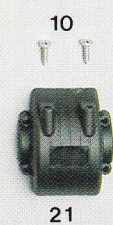

21



31

| N. Ident N. | Descrizione - Description |
|-------------|---|
| 1 2490 | Dado autobloccante - Stop nut 4 MA |
| 2 2667 | Vite autofilettante - Self tapping screw mm. 3,9x22 |
| 3 2673 | Vite autofilettante - Self tapping screw mm. 2,9x6,5 |
| 4 2675 | Vite autofilettante - Self tapping screw mm. 2,9x16 |
| 5 2684 | Vite autofilettante - Self tapping screw mm. 2,9x13 |
| 6 2685 | Vite autofilettante - Self tapping screw mm. 3,9x16 |
| 7 2698 | Rondella - Washer ø mm. 4 |
| 8 20822 | Vite autofilet. TS - Self tapping screw mm. 3,5x19 |
| 9 20835 | Rasamento - Steel washer ø mm. 6x12x0,3 |
| 10 20859 | Vite autofilet. TS - Self tapping screw mm. 3,5x13 |
| 11 20882 | Vite - Screw TC MA 3x20 mm. |
| 12 22327 | Cuscinetto - Ball-bearing ø mm. 6x19x6 |
| 13 22415 | Grano - Screw MA 4x20 mm. |
| 14 22676 | Vite - Screw TE MA 4x25 mm. |
| 15 24211 | Pignone conico e ras. - Bevel gearwheel & washers |
| 16 24225 | Ammortizzatori completi - Shock absorbers |
| 17 24226 | Molla ammortizzatori - Coil spring |
| 18 24231 | Telaio - Chassis |
| 19 24260 | Bracci sospensione anteriore Transverse swinging arms, front |
| 20 24261 | Bracci sospensione posteriore Transverse swinging arms, rear |
| 21 24262 | Casse differenziale - Differential housing |
| 22 24264 | Supporti portamozzi ant. - Front stub axle support |
| 23 24265 | Supporto sospensione - Axle support |
| 24 24266 | Supporto sospensione superiore Upper suspension support |
| 25 24267 | Paraurti e supporti carrozzeria Front bumper & body supports |
| 26 24271 | Differenziale completo - Differential |
| 27 24357 | Grano - Screw MA 4x12 mm. |
| 28 24362 | Vite - Screw TE 4x19 mm. |
| 29 3301071 | Cuscinetto - Ball-bearing ø mm. 7x19x6 |
| 30 3303048 | Ghiera ammortizzatori Adjusting collar for shockabsorbers |
| 31 3308008 | Cerchi - Rims |

A

| N. Ident N. | Descrizione - Description |
|-------------|--|
| 1 2322 | Collare - Collar ø mm. 3,2 |
| 2 2323 | Collare - Collar ø mm. 2,2 |
| 3 2490 | Dado autobloccante - Stop nut 4 MA |
| 4 2491 | Dado autobloccante - Stop nut 3 MA |
| 5 2636 | Vite - Screw TC MA 3x8 mm. |
| 6 2671 | Vite autofilettante - Self tapping screw mm. 2,2x9,5 |
| 7 2675 | Vite autofilettante - Self tapping screw mm. 2,9x16 |
| 8 2697 | Rondella - Washer ø mm. 3 |
| 9 2698 | Rondella - Washer ø mm. 4 |
| 10 20038 | Uniball - Uniball ø mm. 6 |
| 11 20108 | Snodo acceleratore - Linkage swivel |
| 12 20110 | Kit uniball - Set uniball ø mm. 4 |
| 13 20221 | Seger per albero - Circlip ø mm. 5 |
| 14 20247 | Rullino - Pin ø mm. 2,5x17,8 |
| 15 20270 | Seger per albero - Circlip ø mm. 7 |
| 16 20272 | Rondella - Washer ø mm. 7x14x0,5 |
| 17 20258 | Clips - Clips |
| 18 20286 | Campana - Cutch bell Z 13 |
| 19 20290 | Ceppi frizione - Clutch shoe |
| 20 20291 | Molla frizione - Clutch spring |
| 21 20293 | Dado motore - Engine nut |
| 22 20295 | Cuscinetto a rullini - Needle-bearing ø mm. 5x8x10 |
| 23 20297 | Rasamento - Steel washer ø mm. 5x10x0,2 |
| 24 20513 | Vite - Screw TE MA 4x12 mm. |
| 25 20536 | Volano - Flywheel |
| 26 20624 | Grano - Screw MA 4x5 mm. |
| 27 20859 | Vite autofilet. - Self tapping screw TS mm. 3,5x13 |
| 28 20866 | Vite - Screw TC MA 3x14 mm. |
| 29 20882 | Vite - Screw TC MA 3x20 mm. |
| 30 20886 | Serbatoio - Tank |
| 31 20895 | Fermi serbatoio - Tank clamps |
| 32 21862 | Bicchierino - Driving joint ø mm. 5 con grano |
| 33 22221 | Vite - Screw TS MA 4x12 mm. |
| 34 22441 | Tubo antenna - Antenna tubing |
| 35 22462 | Castello motore - Engine mount |
| 36 22676 | Vite - Screw TE MA 4x25 mm. |
| 37 22758 | Salvaservo - Servo saver |
| 38 22974 | Supporti batteria - Supports battery |
| 39 24213 | Corona differenziale centrale Z 56 Crown gear central differential Z 56 |
| 39 24234 | Corona differenziale centrale Z 60 Crown gear central differential Z 60 |
| 40 24214 | Supporto centrale - Central support |
| 41 24216 | Camme freno - Brake axle |
| 42 24218 | Bicchierino centrale - Central driving joint |
| 43 24220 | Pastiglie freno - Brake plate |
| 44 24221 | Bicchierino - Driving joint ø mm. 6 |
| 45 24222 | Omocinetic anteriori - Front omocynetic joints |
| 46 24224 | Asse ruota posteriore - Rear wheel axle |
| 47 24229 | Colonne roll-bar - Roll-bar pillar |
| 48 24230 | Roll-bar - Roll-bar |
| 49 24235 | Differenziale centrale - Central differential |
| 50 24236 | Disco freno - Brake disc Carbotek |
| 50 24219 | Disco freno - Brake disc Ergal |
| 51 24243 | Asse anteriore - Front axle |
| 52 24244 | Asse posteriore - Rear axle |
| 53 24245 | Cardani posteriori - Driving joint |
| 54 24247 | Salvaservo - Servo saver |
| 55 24248 | Colonna salvaservo - Servo saver pillar |
| 56 24263 | Portamozzi - Stub axle |
| 57 24267 | Paraurti e supporti carrozzeria Front bumper & body supports |
| 58 24268 | Piastra radio - Radio plate |
| 59 24301 | Barra posteriore - Rear stabilizer rod |
| 60 24355 | Rullini - Pin ø mm. 3x25 |
| 61 24356 | Testina uniball - Uniball head ø mm. 6 |
| 62 24366 | Grano - Screw MA 3x3 mm. |
| 63 3301020 | Tirante freno - Brake linkage |
| 64 3301071 | Cuscinetto - Ball-bearing ø mm. 7x19x6 |
| 65 3303050 | Testina uniball - Uniball head ø mm. 6 |
| 66 3303054 | Asta sterzo - Steering linkage ø mm. 3 |
| 67 3303057 | Registro freno completo - Brake tuning |
| 68 3303058 | Asta sterzo - Steering linkage ø mm. 2 |
| 69 3941000 | Gomma posteriore super grip - Rear super grip tyre |
| 70 3959000 | Gomma anteriore AP - Front AP tyre |
| --- 24253 | Carrozzeria - Body |

B

Art. 782002900

Carrozzeria in Lexan per telaio snodato
Lexan body for knee chassis

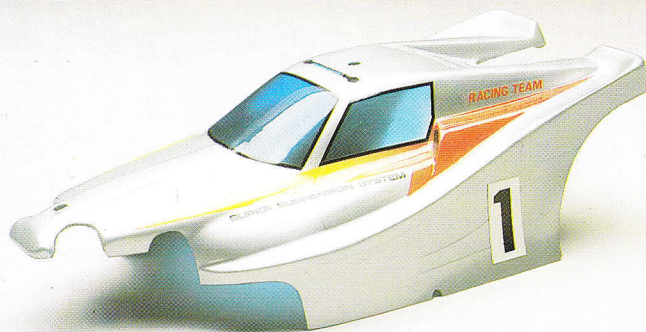

Art. 24499 Buggy Japan

Carrozzeria in Lexan
Lexan body





70

B

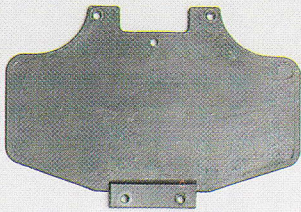

57



70

RICAMBI

SPARE PARTS

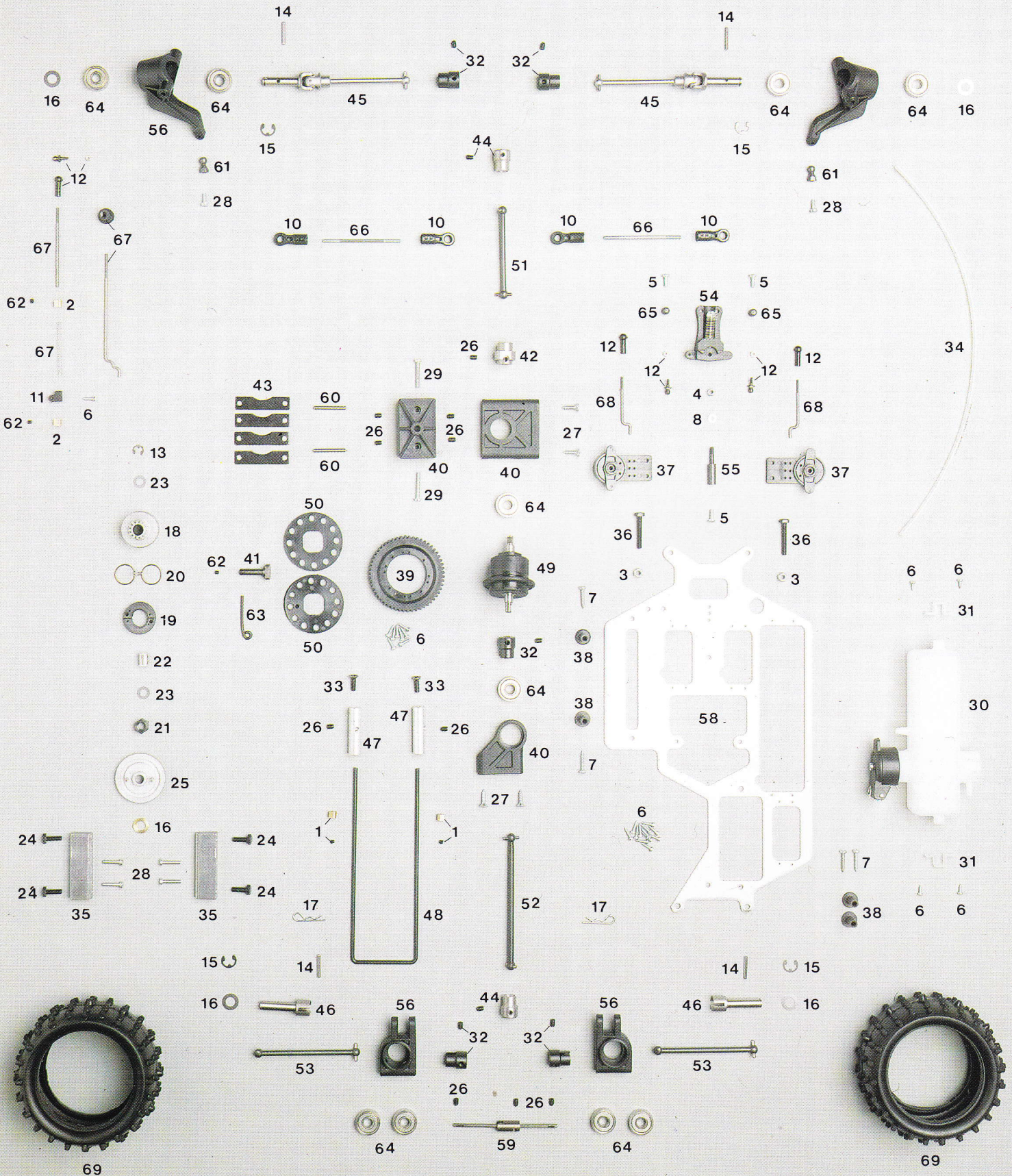

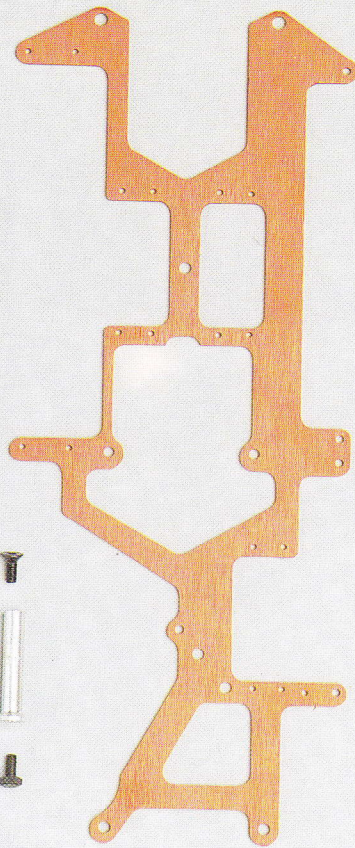
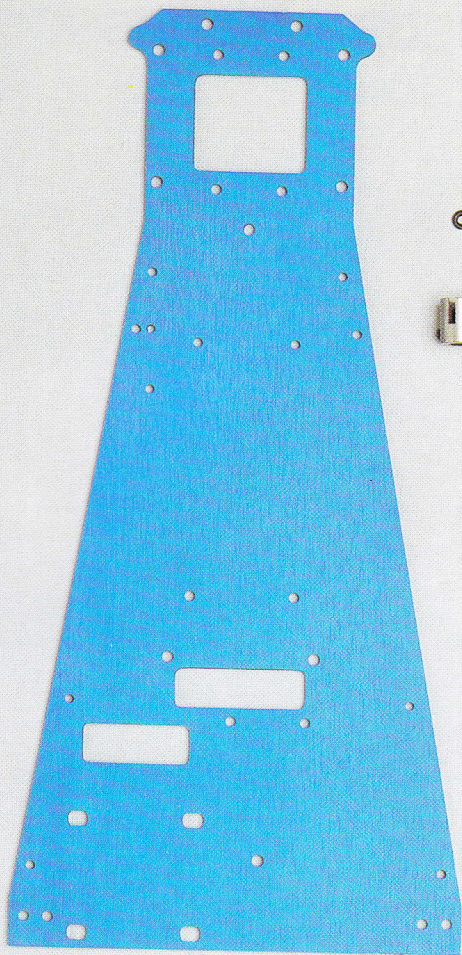

**Art. 24485
Kit telaio snodato
Knee chassis set**

La confezione comprende: il telaio completo, la piastra radio, l'ammortizzatore centrale e tutta la minuteria per il montaggio eccetto il gruppo rinvio sterzo.

The kit contains: the knee chassis, the new radio plate, the fifth shock absorber & the moulding parts except the steering linkage.

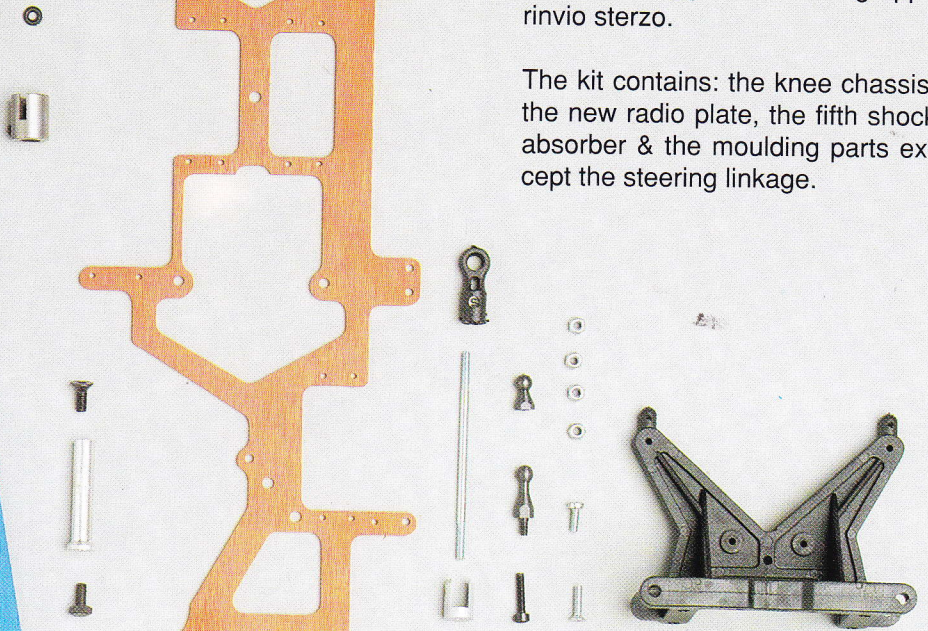

**Art. 24488
Kit ammortizzatore centrale completo
Central shock absorber set**

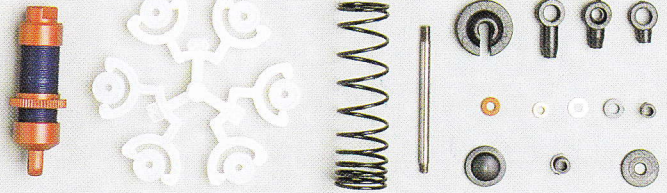
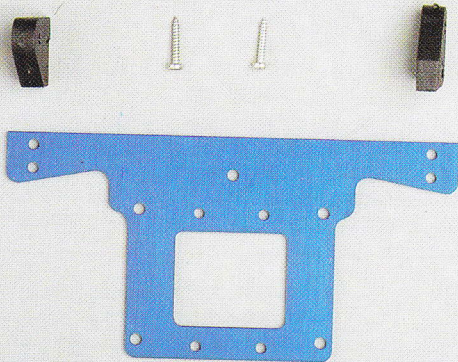

**Art. 24486
Kit tiranteria - Linkage set**

La confezione comprende: tutte le parti in nylon, uniball, tiranti dello sterzo e minuteria.

The kit contains: the nylon parts, the uniballs the rods etc.

**Art. 24487
Kit protezione laterale marmitta
Side muffler protection set**

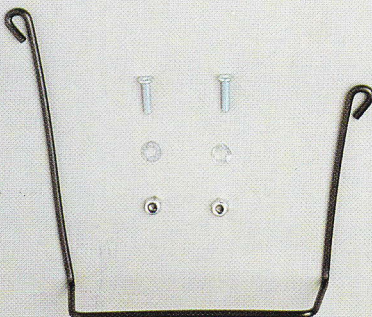

**Art. 24232
Kit supporto marmitta
Support muffler set**

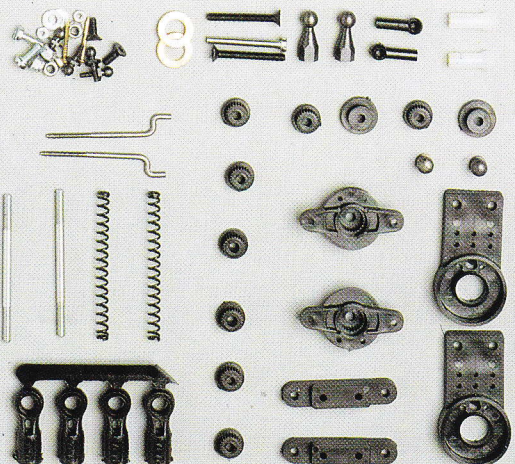



ACCESSORI ACCESSORIES

TORSEN RICAMBI SPARE PARTS

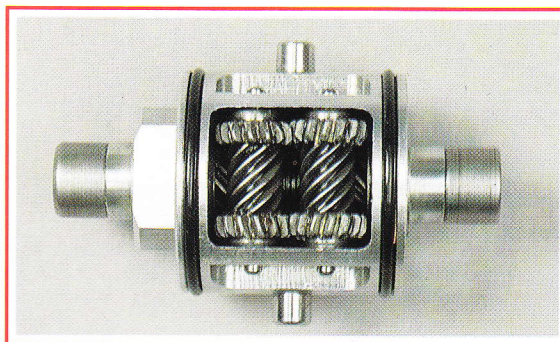
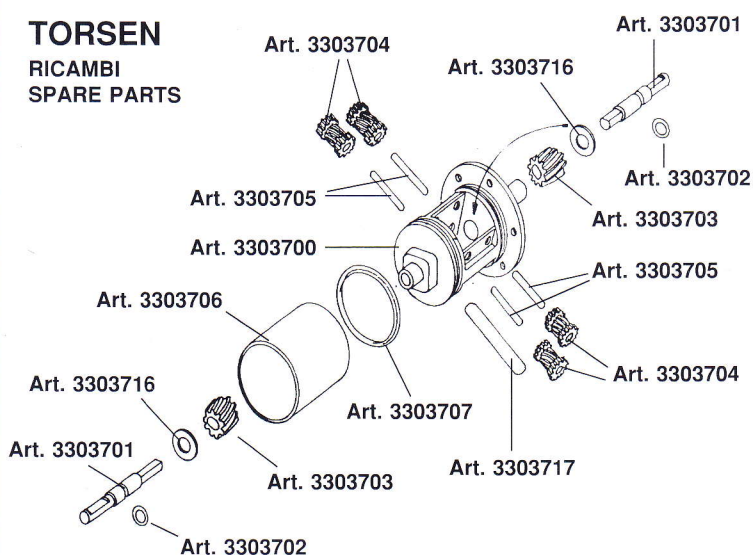

Art. 24215

Il **differenziale TORSEN**, definito dai tecnici "intelligente", permette un maggior scarico di potenza sulle ruote evitando lo slittamento in uscita delle curve o dopo i salti fornendo sempre la stessa coppia ad entrambe le ruote. E' stato realizzato identico all'originale impiegato da Lancia, Lotus, Ferrari con la sola eliminazione di due viti senza fine. Siamo gli unici al mondo che producono un simile differenziale.

The **TORSEN differential**, called "clever unit", guarantee the automatic distribution of the power on each wheel in any circuit condition. This device is a scale copy of the Ferrari - Lancia - Lotus differentials with two pairs of endless screws instead of three for space problems.

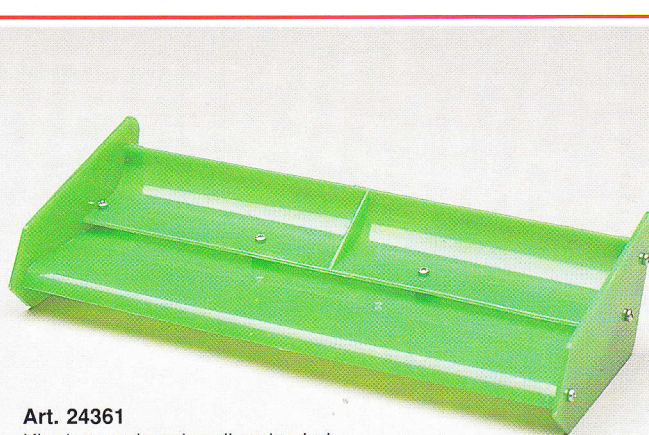
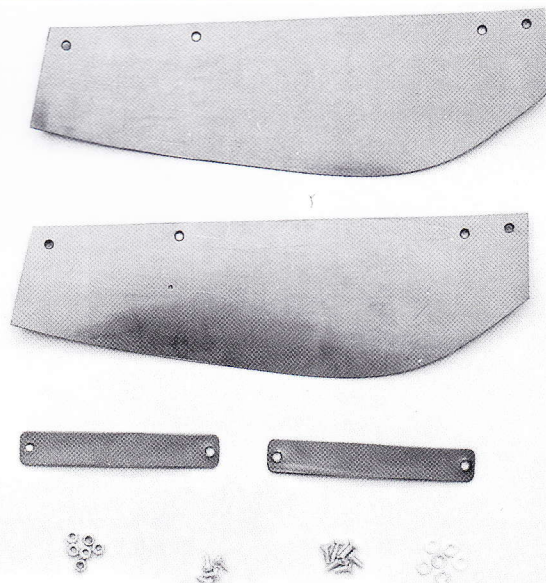
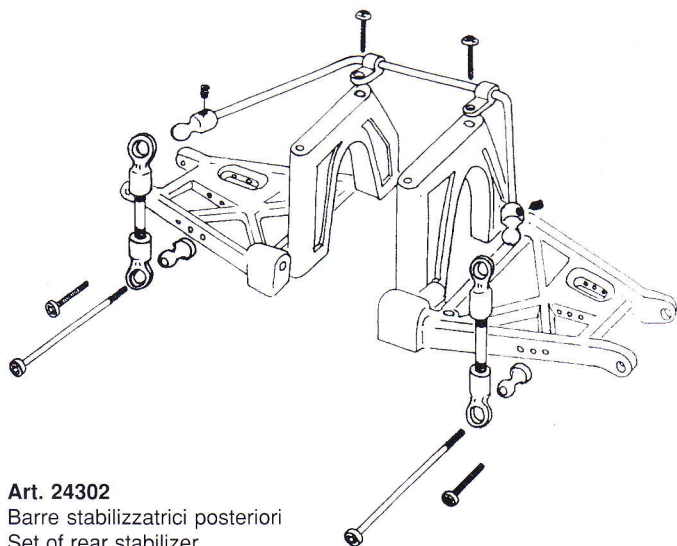



ACCESSORI - ACCESSORIES

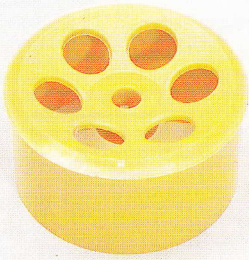

Art. 24349
Cerchio di vari colori
Rim - different colours



GOMME - TYRES

- 1 Art. 3349000 Anteriore - Front
- 2 Art. 3941000 AP super grip - Super grip AP
- 3 Art. 3949000 Tractor - Tractor
- 4 Art. 3950000 AP anteriore - Front AP
- 5 Art. 3957000 Super grip tonda - Rond super grip
- 5 Art. 3966000 Super grip tonda sintetica - Rond super grip
- 6 Art. 3959000 AP anteriore - Front AP
- 7 Art. 3962000 Minispikes - Minispikes
- 7 Art. 3965000 Minispikes sintetica - Minispikes - syntetic
- 8 Art. 3963000 Riccio - Riccio
- 8 Art. 3967000 Riccio sintetica - Riccio - syntetic
- 9 Art. 3960000 Magik morbida - Soft magik
- 9 Art. 3964000 Magik media - Medium magik
- 10 Art. 3970000 Spugna dura - Hard foam
- 11 Art. 3971000 Spugna morbida - Soft foam
- 12 Art. 1566 Colla cianoacrilica liquida 20 g - Istant glue - fast 20 g
- 13 Art. 1565 Colla cianoacrilica media 20 g - Istant glue - medium 20 g
- 14 Art. 1568 Colla cianoacrilica densa 20 g - Istant glue - slow 20 g
- 15 Art. 1005 Colla cianoacrilica media 3 g - Istant glue - medium 3 g



Olio al silicone per ammortizzatori
Shock absorber silicone oil
Art. 3303655 350 bianco - white
Art. 3303656 500 verde - green
Art. 3303657 1000 rosso - red

- 1 Art. 24350 Cerchi - Rims
- 2 Art. 24351 Bloccaggi cerchi - To lock a wheel
- 3 Art. 24352 Dado e rondella - Nut & washer
- 4 Art. 24353 Bussola - Bearing
- 5 Art. 22921 Cuscinetto \varnothing mm. 10x19x5 - Ball-bearing \varnothing 10x19x5 mm

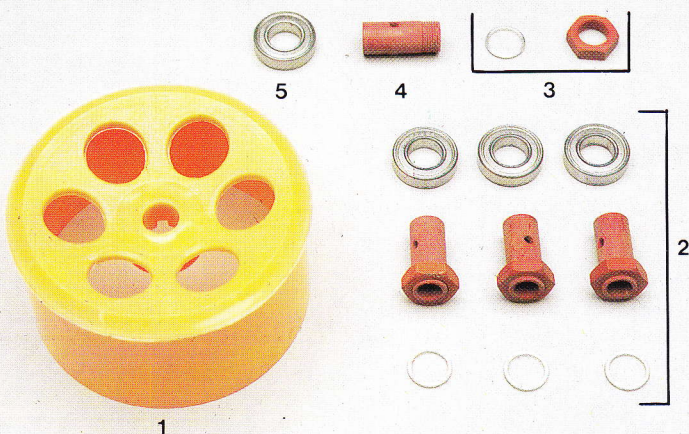

Ammortizzatori a volume costante
Permanent oil volume shock-absorber
Art. 24324 \varnothing 14 Posteriore - Rear
Art. 24325 \varnothing 14 Anteriore - Front

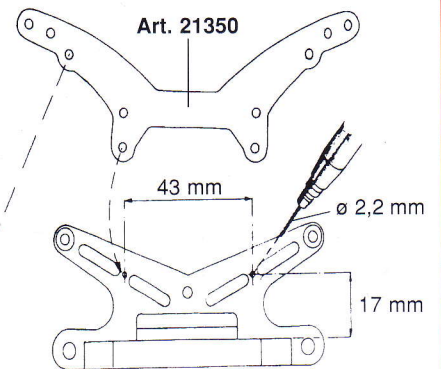

Schema di montaggio supporto
posteriore per ammortizzatori a
grande volume.
Large volume shock-absorber
mounting support.



ACCESSORI ACCESSORIES



Art. 20820
Cassetta d'avviamento nuda
Empty starting box



Art. 20821
Cassetta d'avviamento
completa di motore
Starting box with engine

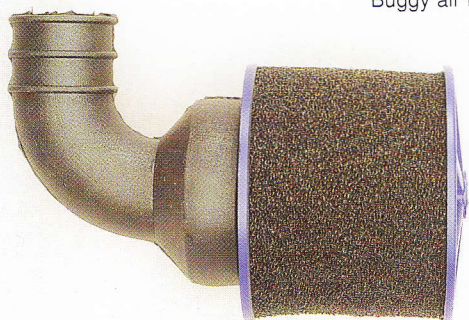

Art. 20129
Gruppo filtro buggy
Buggy air filter set



MISCELE CAR FUELS

Art. 1048 5 litri - liters
Art. 1049 5 litri - liters

Art. 1050 1 litro - liter

Nitromethane
Art. 1076 1 litro - liter
Art. 1077 5 litri - liters

CAMPANE - BELL PINIONS

Art. 20296 Z 11

Art. 20286 Z 13

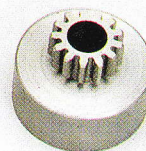
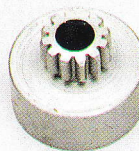

Art. 20439
Pipa espansione
Pipe

Art. 60219
Molla - Spring

Art. 22734
Collettore
Manifold

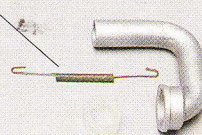

Bombolino
Exhaust
Art. 3315000



Art. 20572



Art. 20571



Art. 20259
Clips

Fascette in nylon

Nylon strips

Art. 20100
Tubo silicone - Exhaust silicone

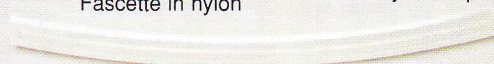

Art. 1090
Riempitore rapido
Quick fuel primer



Art. 2421
Tubo miscela
Fuel tubing



Anelli elastici
Rubber rings
Art. 2422 40 mm
Art. 2423 65 mm
Art. 2424 75 mm

Art. 2419
Filtro miscela
Fuel filter

GRUPPI FRIZIONE - CLUTCH SET

EXPERT
Teflon
Art. 20290

BUGGY
Carbon
Art. 20300

PRO
Ergal-carbon
Art. 20301

