



**NEW**

**MANTUA MODEL GROUP**

# PEUGEOT 405 T16

Il PEUGEOT 405 T16 è un automodello in scala 1:8 con avviamento a strappo studiato per coloro che si avvicinano per la prima volta all'automodellismo.

L'eliminazione della batteria a 12 volt e dell'avviatore a mano o in cassetta, rendono assai più semplice l'uso del modello. Il kit 4WD fornito come optional permette la trasformazione in quattro ruote motrici. Il nuovo sistema è stato ampiamente collaudato per lungo tempo realizzando anche un motore specifico. Per le sue caratteristiche tecniche, semplicità di montaggio e regolazioni, il PEUGEOT 405 T16 è destinato a diventare il modello degli anni '90.

The PEUGEOT 405 T16 is the model car, 1:8 scale, with pull starter system, mainly suitable for beginners.

The 12 volt big battery & the electric starter are not any more requested, reducing the dependence from heavy & high cost devices. A 4x4 conversion kit from 2WD is available for the best performance of a 4WD. Then new system have been tested for a long time projecting a special engine for this purpose.

PEUGEOT 405 T16 mit Seilzugstarter und 3,5 cm<sup>3</sup> Motor ist das ideale Einsteigermodell im Maßstab 1:8.

Funktioneller, wartungs freundlicher Aufbau und ein ansprechendes Design sind die kennzeichnenden Merkmale. Ein integrierter Seilzugstarter erleichtert das Anlassen enorm und macht einen Elektro-Starter mitsamt Batterie überflüssig.

Der mitgelieferte 3,5 cm<sup>3</sup> Motor ist mit Luftfilter und Schalldämpfer ausgerüstet. Das serienmäßig mit Hinterrad antrieb betriebene Modell kann mit einem 4-WD Umrüstsatz.

**Art. 785000000**



## 2WD

**AVVIAMENTO A STRAPPO  
STRAP STARTING SYSTEM  
SEILZUGSTARTER**

### DATI TECNICI

Passo .....  
Carreggiata anteriore .....  
Carreggiata posteriore .....  
Peso con motore, marmitta,  
radio e carrozzeria .....

### TECHNICAL DATA

Wheel base .....  
Front track .....  
Rear track .....  
Weight with engine, muffler,  
radio and body .....

### TECHNISCHE DATEN

Achsabstand ..... 327 mm  
Radstand vorn ..... 265 mm  
Radstand hinten ..... 255 mm  
Gewicht mit Motor, Schalldämpfer,  
RC-Anlage und Karosserie..... 2750 gr.





35



26

6

6

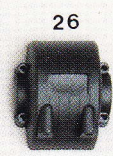

26

12

12



35

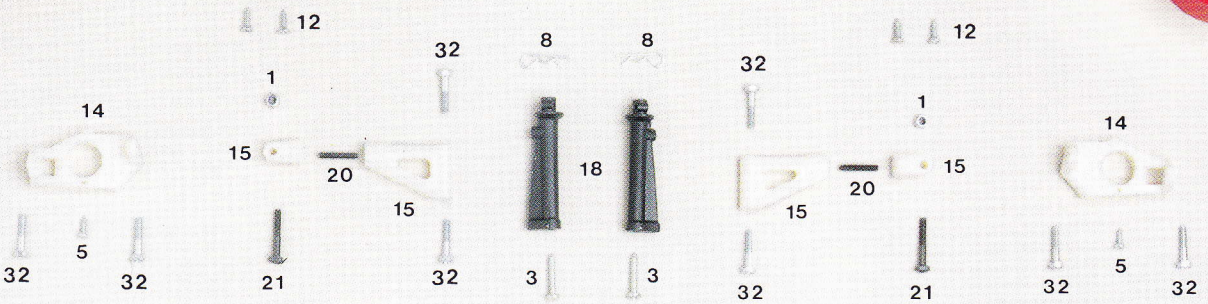

14

15

20

15

8

8

18

3

3

1

32

5

32

21

32

32

15

20

15

21

32

14

5

32

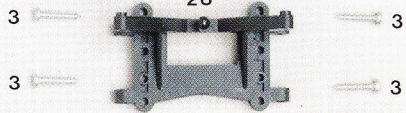

28

3

3

3

3

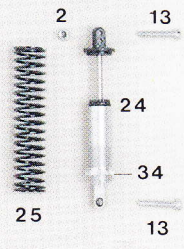

2

13

24

34

25

13



32

31

32

15

32

32

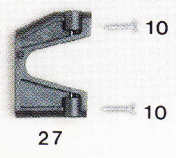

10

10

27

10

10



32

32

15

32

32

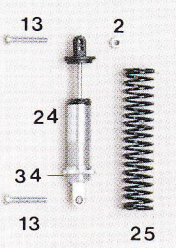

13

2

24

34

25

13

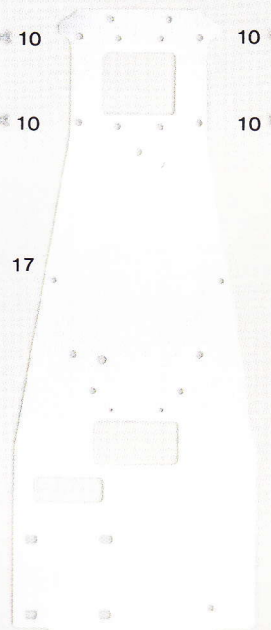

17



22

4

4

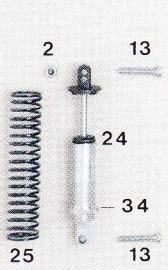

2

13

24

34

25

13

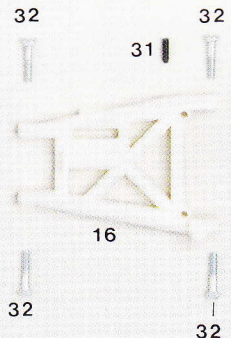

32

31

32

16

32

32

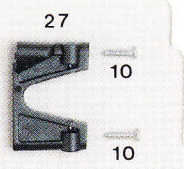

10

10

27

10

10

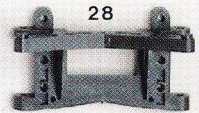

28

3

3

3

3

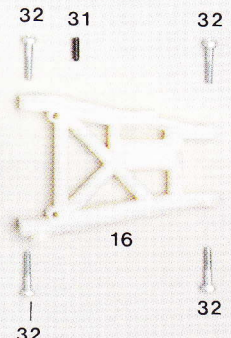

32

31

32

16

32

32

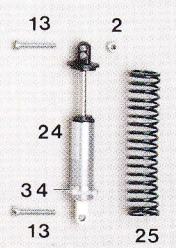

13

2

24

34

25

13

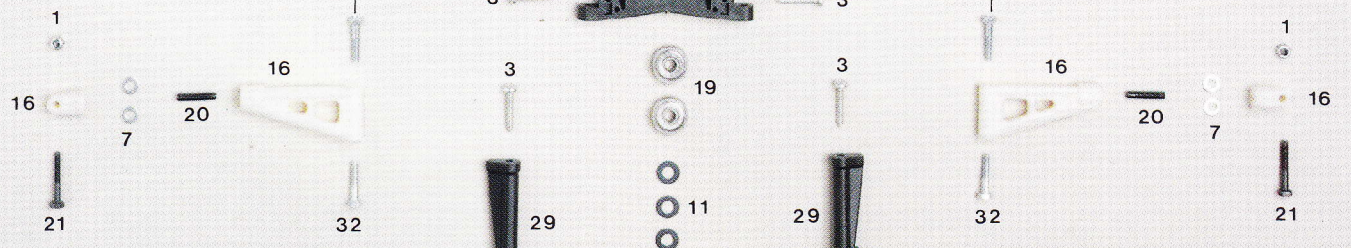

16

20

7

32

21

1

16

20

7

32

21

12

29

11

8

23

19

11

29

8

16

20

32

21

12

6

6

26

33

30

33

26



35



35



# PEUGEOT 405 T16

RICAMBI - SPARE PARTS  
EINZELTEILE auf Abbildung links

N.	Articolo Ident N.	Descrizione Description	N.	Best.-Nr.	Bezeichnung
1	2490	Dado autobloccante - Stop nut 4 MA	1	2490	Stopmutter M 4
2	2491	Dado autobloccante - Stop nut 3 MA	2	2491	Stopmutter M 3
3	2667	Vite autofilettante - Self tapping screw ø mm. 3,9x22	3	2667	Blechschrauben ø 3,9 x 22 mm
4	2673	Vite autofilettante - Self tapping screw ø mm. 2,9x6,5	4	2673	Blechschrauben ø 2,9 x 6,5 mm
5	2674	Vite autofilettante - Self tapping screw ø mm. 2,9x9,5	5	2674	Blechschrauben ø 2,9 x 9,5 mm
6	2675	Vite autofilettante - Self tapping screw ø mm. 2,9x16	6	2675	Blechschrauben ø 2,9 x 16 mm
7	2698	Rondella - Washer ø mm. 4	7	2698	Unterlagscheibe ø 4 mm
8	20258	Clips carrozzeria - Body clips	8	20258	Karosserieklammer
--	--	Olio per ammortizzatori - Shock absorber oil	--	20648	Stoßdämpferöl
10	20822	Vite autofilettante TS - Self tapping screw ø mm. 3,5x19	10	20822	Blechschrauben ø 3,5 x 19 mm
11	20835	Rasamento - Steel washer ø mm. 6x12x0,3	11	20835	Stahlscheibe ø 6 x 12 x 0,3 mm
12	20859	Vite autofilettante TS - Self tapping screw ø mm. 3,5x13	12	20859	Blechschrauben ø 3,5 x 13 mm
13	20882	Vite - Screw MA 3x20 mm.	13	20882	Schraube M 3 x 20 mm
14	21708	Supporto portamozzo anteriore - Front stub axle support	14	21708	Vorderer Achsschenkelhalter
15	21710	Bracci sospensione anteriore - Front suspension arm	15	21710	Querlenker, vorn
16	21711	Bracci sospensione posteriore - Rear suspension arm	16	21711	Querlenker, hinten
17	21713	Telaio - Chassis	17	21713	Chassis
18	21714	Colonna carrozzeria - Body pillar	18	21714	Karosseriehalterung
19	22327	Cuscinetto - Ball-bearing ø mm. 6x19x6	19	22327	Kugellager ø 6 x 19 x 6 mm
20	22415	Grano - Screw MA 4x20 mm.	20	22415	Inbusgewindestifte M 4 x 20 mm
21	22676	Vite TE - Screw MA 4x25 mm.	21	22676	Schraube M 4 x 25 mm
22	22864	Salvacorona - Gear saver	22	22864	Zahnradschutz
23	24211	Pignone conico - Bevel gear & shaft	23	24211	Kegelzahnrad mit Welle
24	24225	Ammortizzatori completi - Shock absorbers	24	24225	Stoßdämpfer
25	24226	Molle ammortizzatori - Shock absorber spring	25	24226	Schraubenfeder für Stoßdämpfer
26	24262	Casse esterne - Differential casing	26	24262	Satz Differentialgehäuse
27	24265	Montante sospensione - Axle support	27	24265	Achsbock
28	24266	Supporto superiore - Upper support	28	24266	Obere Aufhängungsbefestigung
29	24267	Colonna carrozzeria - Body pillar	29	24267	Karosseriehalterung
30	24271	Differenziale posteriore - Rear differential	30	24271	Differential, hinten
31	24357	Grano - Screw MA 4x12 mm	31	24357	Inbusgewindestifte M 4 x 12 mm
32	24362	Vite - Screw ø mm. 4x19	32	24362	Schraube ø mm. 4 x 19
33	3301071	Cuscinetto - Ball-bearing ø mm. 7x19x6	33	3301071	Kugellager ø 7 x 19 x 6 mm
34	3303048	Ghiera di registro - Tuning nut	34	3303048	Stelling für Stoßdämpfer
35	782502800	Cerchio - Rim	35	782502800	Felgen
--	20397	Carrozzeria - Body	--	20397	Karosserie
--	20398	Alettone - Spoiler	--	20398	Spoiler
--	20453	Serie decals - Decals set	--	20453	Abziehbilder für Karosserie

## OPTIONAL Wahlweise



Art. 22886  
per - for - für Junior  
Marmitta per 4WD  
Special 4WD muffler  
4WD Schalldämpfer

Art. 22592 per - for - für Force  
Marmitta per 4WD  
Special 4WD muffler  
Specialschalldämpfer  
für 4WD

Art. 331010 per - for - für Junior-Motor  
Kit trasformazione 4WD completo di marmitta  
Conversion kit 4WD with muffler  
Ausbausatz für Vierradantrieb mit Schalldämpfer

Art. 331011 per - for - für Force-Motor  
Kit trasformazione 4WD completo di marmitta  
Conversion kit 4WD with muffler  
Ausbausatz für Vierradantrieb mit Schalldämpfer





54

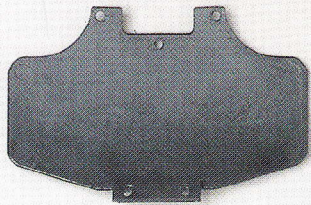

47



54

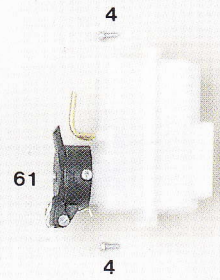
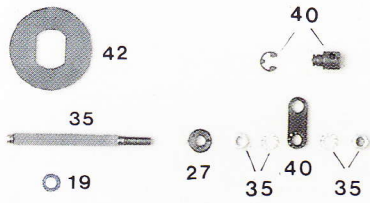
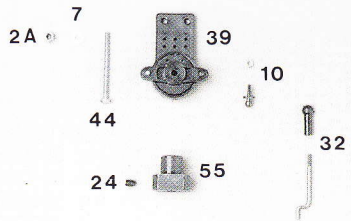
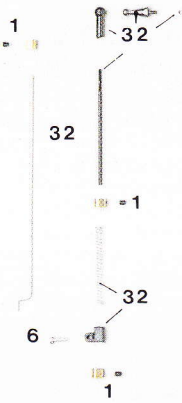
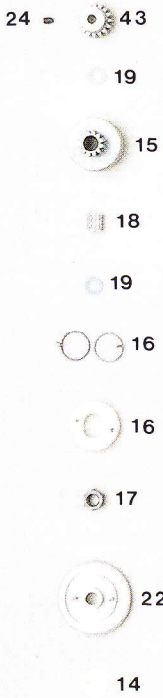
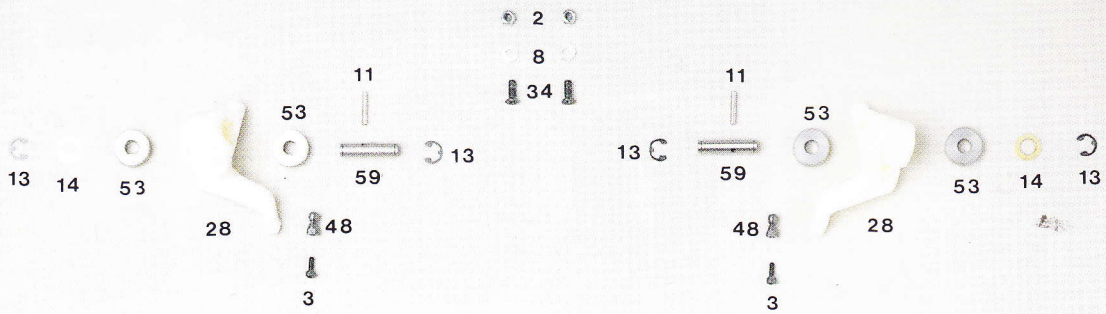

37

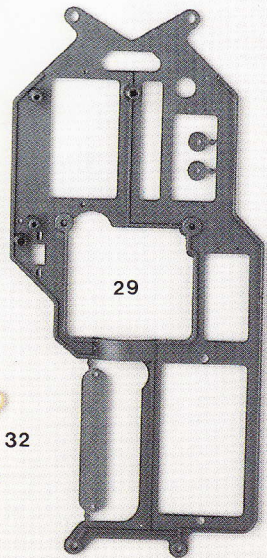
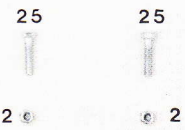
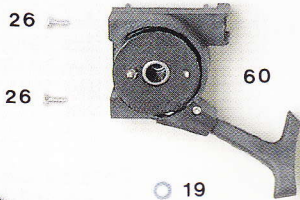
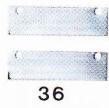

30

30

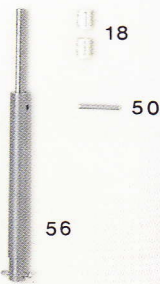
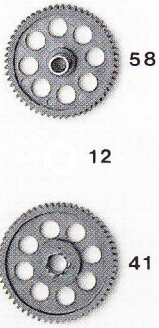
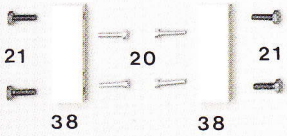

62

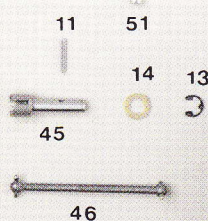
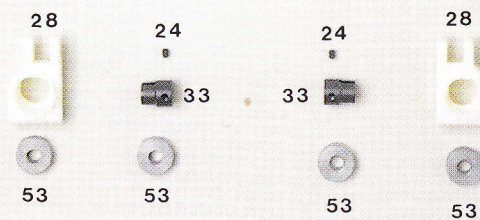
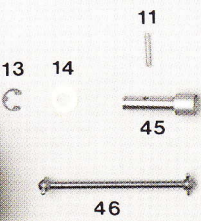

62



N.	Articolo Ident N.	Descrizione Description	Nr.	Best.-Nr.	Bezeichnung
1	2323	Collare - Collar ø mm. 2,5	1	2323	Stellringe ø 2,5 mm
2	2490	Dado autobloccante - Stop nut 4 MA	2	2490	Stopmutter M 4
2A	2491	Dado autobloccante - Stop nut 3 MA	2A	2491	Stopmutter M 3
3	2636	Vite - Screw MA 3x8 mm.	3	2636	Zylinderschrauben M 3 x 8 mm
4	2639	Vite - Screw MA 3x16 mm.	4	2639	Zylinderschrauben M 3 x 16 mm
--	2671	Vite autofilettante - Self tapping screw ø mm. 2,2x9,5	--	2671	Blehschrauben ø 2,2 x 9,5 mm
6	2674	Vite autofilettante - Self tapping screw ø mm. 2,9x9,5	6	2674	Blehschrauben ø 2,9 x 9,5 mm
7	2697	Rondella - Washer ø mm. 3	7	2697	Unterlagscheiben ø 3 mm
8	2698	Rondella - Washer ø mm. 4	8	2698	Unterlagscheiben ø 4 mm
9	20038	Uniball - Uniball ø mm. 6	9	20038	Gelenkpfannen ø 6 mm
10	20110	Sfera per uniball - Ball for uniball ø mm. 4	10	20110	Kugelkopf ø 4 mm
11	20247	Rullino - Pin ø mm. 2,5x17,8	11	20247	Stift ø 2,5 x 17,8 mm
12	20250	Rasamento - Steel washer ø mm. 10x18x0,3	12	20250	Stahlscheibe ø 10 x 18 x 0,3 mm
13	20270	Sege per albero - Circlip ø mm. 7	13	20270	Sicherungsscheiben ø 7 mm
14	20272	Rondella - Washer ø mm. 7x14x0,5	14	20272	Unterlagscheiben ø 7 x 14 x 0,5 mm
15	20286	Campana - Clutch bell Z 13	15	20286	Kupplungsglocken 13 Zähne
16	20290	Ceppi frizione - Clutch shoe	16	20290	Kupplungsbacken
17	20293	Dado motore - Engine nut	17	20293	Motormutter
18	20295	Cuscinetto a rullini - Needle-bearing ø mm. 5x8x10	18	20295	Nadellager ø 5 x 8 x 10 mm
19	20297	Rasamento - Steel washer ø mm. 5x10x0,2	19	20297	Stahlscheibe ø 5 x 10 x 0,2 mm
20	20508	Vite - Screw MA 3x12 mm.	20	20508	Schraube M 3 x 12 mm
21	20513	Vite TE - Screw MA 4x12 mm.	21	20513	Schraube M 4 x 12 mm
22	20536	Volano - Flywheel	22	20536	Schwungscheibe
23	20572	Fascette in nylon - Nylon tie-wrap	23	20572	Nylon-Kabelbinder
24	20624	Grano - Screw MA 4x5 mm.	24	20624	Inbusgewindestifte M 4 x 5 mm
25	20846	Vite TE - Screw MA 4x20 mm.	25	20846	Schraube M 4 x 20 mm
26	20859	Vite autofilettante TS - Self tapping screw ø mm. 3,5x13	26	20859	Blehschraube ø 3,5 x 13 mm
27	20865	Boccola del freno - Brake bearing	27	20865	Bremsswellenlager
28	21709	Portamozzi - Stub axle	28	21709	Achsschenkel
29	21712	Piastra radio - Radio plate	29	21712	Radioplatte
30	21715	Vite autofilettante TS - Self tapping screw ø mm. 3,9x13	30	21715	Blehschraube ø 3,9x13 mm
31	21716	Tirante - Steering ø mm. 3x65	31	21716	Gestänge ø 3x65 mm
32	21717	Kit tiranteria - Linkage set	32	21717	Gestänge, Satz
33	21862	Bicchierino laterale - Driving joint	33	21862	Kupplungsstück
34	22221	Vite TS - Screw MA 4x12 mm.	34	22221	Schraube M 4 x 12 mm
35	22402	Camme del freno - Brake axle	35	22402	Satz Bremswelle
36	22403	Comando freno - Brake linkage	36	22403	Bremsplatte
37	22441	Tubo antenna - Antenna tubing	37	22441	Antennenrohr
38	22461	Castello motore - Engine mount	38	22461	Satz Motorböcke
39	22758	Salvaservo completo - Servo-saver	39	22758	Servo - Saver komplett
40	22852	Colonna regolazione freno - Pillar for brake device	40	22852	Brems-Einstellungzapfen
41	22869	Corona trascinamento - Main gear Z 60	41	22869	Antriebszahnrad 60 Zähne
42	22872	Disco freno - Brake disk	42	22872	Bremsscheibe
43	22878	Ingranaggio motore - Pinion engine Z 16	43	22878	Motorritzel 16 Zähne
44	22907	Vite - Screw MA 3x35 mm.	44	22907	Schraube M 3 x 35 mm
45	24224	Perno ruota posteriore - Rear hub axle	45	24224	Radachse-hinten
46	24245	Cardano - Driving joint	46	24245	Kardanwelle
47	24267	Protezione anteriore - Front bumper	47	24267	Frontrammer
48	24356	Sfere per uniball - Ball for uniball ø mm. 6x12	48	24356	Kugelkopf ø 6x12 mm
--	60219	Molla per marmitta - Spring for exhaust	--	60219	Feder für Schalldämpfer
50	3301007	Rullino - Pin ø mm. 3x21,8	50	3301007	Stift ø 3 x 21,8 mm
51	3301089	Vite autofilettante - Self tapping screw ø mm. 3,9x16	51	3301089	Blehschraube ø 3,9 x 16 mm
52	3303050	Sfera per uniball - Ball for uniball ø mm. 6x8	52	3303050	Kugelkopf ø 6 x 8 mm
53	3305091	Bronzina - Bearing ø mm. 7x19x6	53	3305091	Lagerbuchse ø 7 x 19 x 6 mm
54	3349000	Gomme anteriori - Front tyres	54	3349000	Vorderreifen
55	3310008	Trascinatore disco freno - Brake holder	55	3310008	Bremsscheibenlager
56	3310011	Albero di trasmissione - Transmission axle	56	3310011	Kardanwelle
57	3310012	Bicchierino centrale - Driving joint	57	3310012	Kardanwellenanschluß
58	3310014	Corona avviamento - Starting gear Z 56	58	3310014	Starterzahnrad 56 Zähne
59	3310022	Perno ruota anteriore - Front hub axle	59	3310022	Radachse-vorn
60	3310072	Avviatore a strappo - Strap starting	60	3310072	Seilzugstarter komplett
61	3402035	Serbatoio - Tank	61	3402035	Tank
62	3941000	Gomme posteriori - Rear tyres	62	3941000	Hinterreifen



**Art. 21719**  
Kit roll-bar  
Satz Überrollbügel



**Art. 20627**  
Sege  
Circlip  
Seegerring

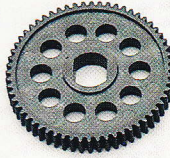

**Art. 3310105**  
Corona per differenziale  
Differential main gear  
Antriebszahnrad für Mitteldifferential

**Art. 3310104**  
Differenziale centrale  
Main differential  
Mitteldifferential

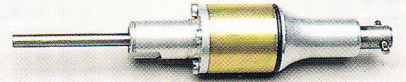

**Art. 3310200**  
Kit differenziale centrale  
Central differential set  
Komplettsatz Mitteldifferential

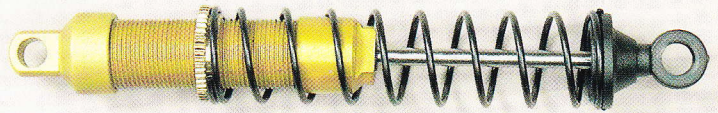

**Art. 24325**  
Ammortizzatori a volume costante  
Permanent oil volume shock-absorbers - Öldruckstoßdämpfer

### GRUPPI FRIZIONE - CLUTCH SET - KUPPLUNGSBACKEN

**EXPERT**  
Teflon  
Art. 20290



**BUGGY**  
Carbon  
Art. 20300

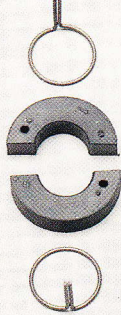

**PRO**  
Ergal-carbon  
Art. 20301



**Art. 3302150** ø mm. 7x19x6  
Kit cuscinetti - Ball-bearing set - Kugellager-Satz

**1 Art. 782002800**  
Cerchi - Rims  
Felgen für Radachsenset

**3 Art. 747002100** ø mm. 10x19x5  
Cuscinetti - Ball-bearing  
Kugellager

**2 Art. 24370**  
Cerchi larghi - Wide rims  
Breite Felgen

**4 Art. 782001200**  
Dado e rondella - Nut & washer  
Mutter und Unterlagscheibe

**2 Art. 24371**  
Cerchi stretti - Narrow rims  
Schmale Felgen

**5 Art. 782001100**  
Boccola - Bearing - Lagerbuchse



**Art. 24222**  
Cardani omocinetic  
Omocynetic joints - Satz Antriebsgelenke vorn

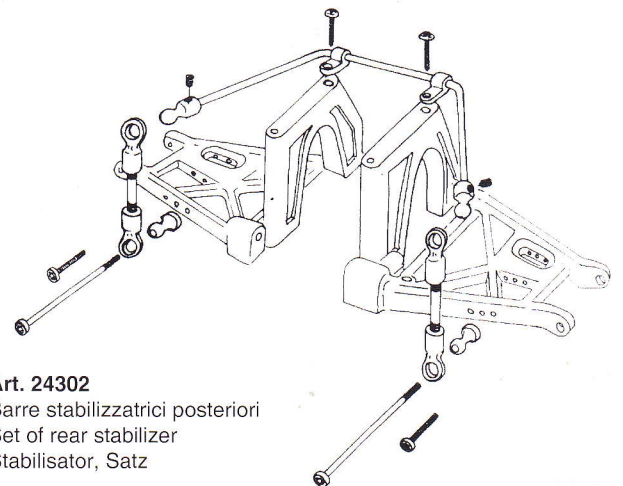

**Art. 24302**  
Barre stabilizzatrici posteriori  
Set of rear stabilizer  
Stabilisator, Satz

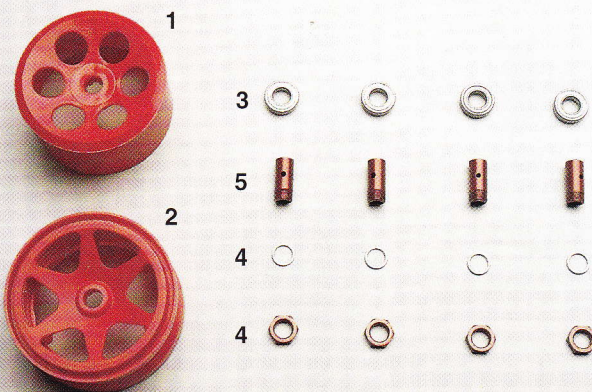





**Art. 60002 FORCE JUNIOR**  
Albero lungo - Long shaft  
mit langer Kurbelwelle



**Art. 1090**  
Riempitore rapido - Quick filler  
Schnellfüllflasche

Anelli elastici - Rubber rings  
Gummiringe

**Art. 2422** ø 40 mm  
**Art. 2423** ø 65 mm  
**Art. 2424** ø 75 mm

**Art. 2421**  
Tubo miscela - Fuel tubing  
Treibstoffschlauch

Clips per carrozzeria  
Body clips  
Karosserieclips

**Art. 2419**  
Filtro miscela  
Fuel filter  
Treibstoff-Filter

**Art. 20258** 25 mm  
**Art. 20259** 30 mm

### MISCELE CAR - FUELS TREIBSTOFF-MISCHUNGEN



**Art. 1048** 5 l. - 10% N.  
**Art. 1049** 5 l. - 5% N.

**Art. 1050** 1 l. - 10 N.

**Nitromethane**  
**Art. 1076** 1 l.  
**Art. 1077** 5 l.

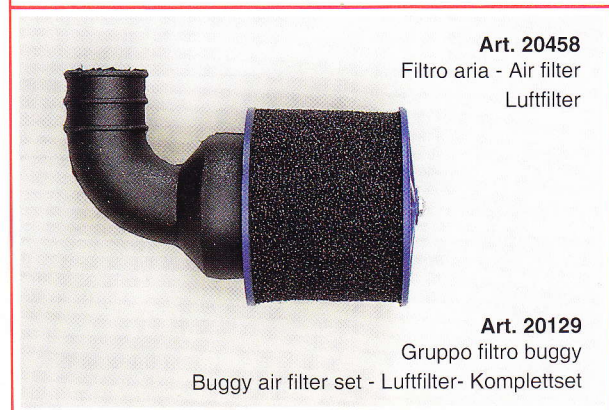

**Art. 20458**  
Filtro aria - Air filter  
Lufffilter

**Art. 20129**  
Gruppo filtro buggy  
Buggy air filter set - Luftfilter- Komplettsset

### GOMME - TYRES - REIFEN *parweise gepackt*

- 1 **Art. 3349000** Anteriore - Front - Frontreifen für 2 WD
- 2 **Art. 3941000** AP super grip - Super grip AP - Buggyreifen Supergrip
- 3 **Art. 3949000** Tractor - Tractor - Buggyreifen Traktorprofil
- 3 **Art. 3976000** Tractor sintetica - synthetic - Traktorprofil synthetik
- 4 **Art. 3950000** AP anteriore - Front AP - Reifen für Sand und Gras
- 5 **Art. 3957000** Super grip - Tonda - Round - Rund
- 5 **Art. 3966000** Super grip - sintetica - synthetic - Synthetik
- 6 **Art. 3959000** AP anteriore - Front AP - Reifen vorn AP
- 7 **Art. 3962000** Minispike - gomma - rubber - Gummi
- 7 **Art. 3965000** Minispike - sintetica - synthetic - Synthetik
- 8 **Art. 3963000** Riccio - Riccio - Reifen Stacheligel rund
- 8 **Art. 3967000** Riccio - sintetica - synthetic - Synthetik
- 9 **Art. 3960000** Magik morbida - Soft magik - Magik weich
- 9 **Art. 3964000** Magik media - Medium magik - Magik mittel
- 9 **Art. 3974000** Ghost - gomma - rubber - Gummi
- 9 **Art. 3975000** Ghost - sintetica - synthetic - Synthetik
- 10 **Art. 3970000** Spugna dura - Hard foam - Zellgummi hart
- 11 **Art. 3971000** Spugna morbida - Soft foam - Zellgummi weich
- Art. 3972000** P 7 - gomma - rubber - Gummi
- Art. 3973000** P 7 - sintetica - synthetic - Synthetik

### Colla cianoacrilica - Istant glue - Sekundenkleber

- 12 **Art. 1566** Liquida - Fast - Schnell - 20 g
- 13 **Art. 1565** Media - Medium - Mittel - 20 g
- 14 **Art. 1568** Densa - Slow - Langsam - 20 g
- 15 **Art. 1005** Media - Medium - Mittel - 3 g

PRINTED IN ITALY

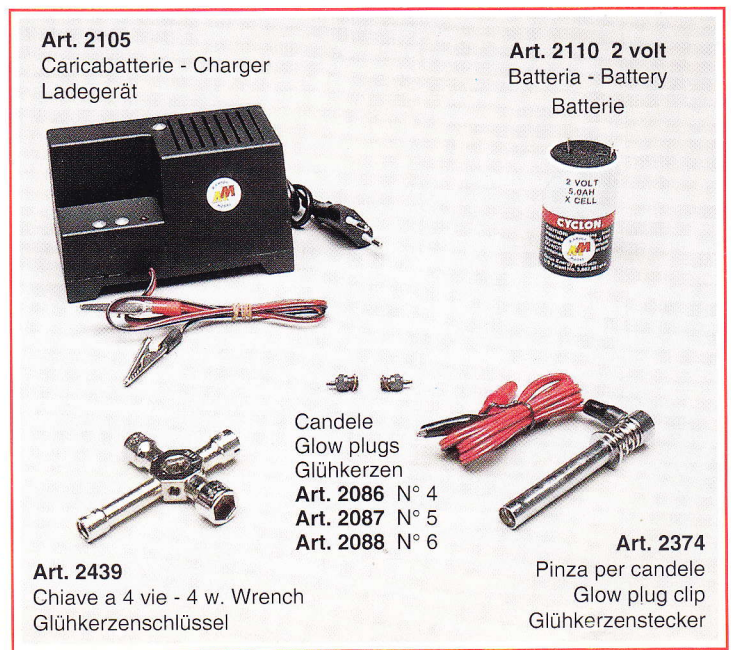

**Art. 2105**  
Caricabatterie - Charger  
Ladegerät

**Art. 2110 2 volt**  
Batteria - Battery  
Batterie

Candele  
Glow plugs  
Glühkerzen  
**Art. 2086** N° 4  
**Art. 2087** N° 5  
**Art. 2088** N° 6

**Art. 2439**  
Chiave a 4 vie - 4 w. Wrench  
Glühkerzenschlüssel

**Art. 2374**  
Pinza per candele  
Glow plug clip  
Glühkerzenstecker





**Art. 24360**  
Supporto alettone per Art. 24361  
Spoiler support for Ident N. 24361  
Halterung-Spoiler für Nr. 24361

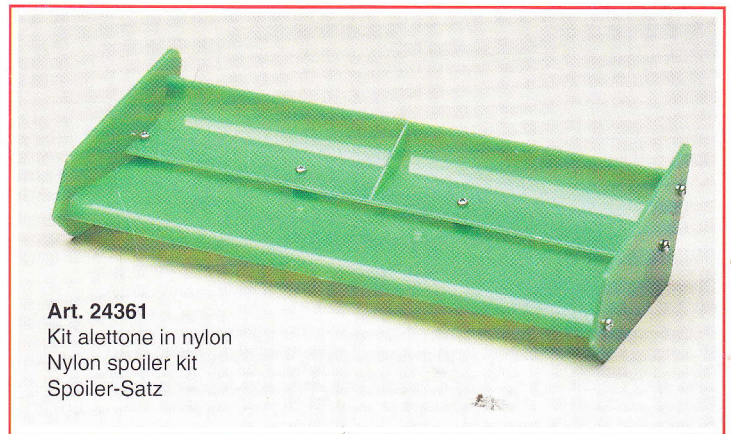

**Art. 24361**  
Kit alettone in nylon  
Nylon spoiler kit  
Spoiler-Satz



**Art. 20444**  
Foglio decals finestrature - Windows decals sheet  
Klebefolien für Fenster

**Art. 20453**  
Foglio decals  
Decals sheet - Zierfolie

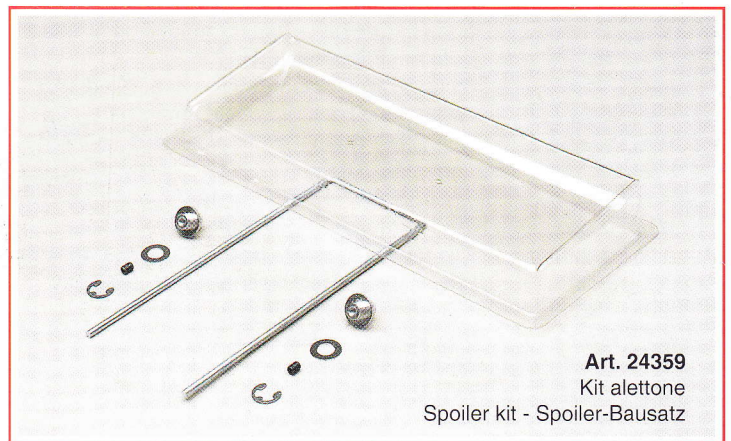

**Art. 24359**  
Kit alettone  
Spoiler kit - Spoiler-Bausatz



Vernici Pactra per le migliori finiture  
Pactra paints for the best finishing  
Pactra-Farben für ein optimales Finish

Consultare il catalogo N. 12  
See catalog N. 12  
Farben siehe Katalog N. 12



**Art. 20395**  
Lancia Delta  
Carrozzeria in Lexan  
Lexan body - Karosserie in Lexan



**Art. 24499** Buggy Japan  
Carrozzeria in Lexan  
Lexan body  
Karosserie in Lexan